

Below Grade, Between Slab, Podium Decks

Description

The CIM waterproofing system is a two-component asphalt-modified polyurethane that forms a tough elastomeric barrier to water. CIM is used to waterproof critical spaces and is ideal for use below grade, between slab, and podium deck applications.

CIM waterproofing systems are cold applied and may be installed in a single application. CIM bonds tenaciously to most common construction materials. The cured waterproofing provides a seamless barrier that is UV stable and suitable for below grade applications where ponding water is present. It is also extremely tough, and no protection board is required.

Advantages

- High solids, low odor and VOC compliant
- Bonds to most construction materials including asphalt
- Bridges new cracks in concrete up to 1/4"
- Cures quickly in all temperatures
- Suitable for ponding water
- Impermeable chemistry
- Cold liquid applied, easy to apply
- Tough enough to support traffic
- UV stable
- Can be applied to complex areas with multiple penetrations



Packaging

CIM Waterproofing Materials

5-gallon units, 1-gallon kits, dual cartridges

Please contact C.I.M. Industries or your local distributor for specific product recommendations.

CIM 61BG Epoxy Primer and Bonding Agent

5-gallon units and 1-gallon units

CIM Accessories

Scrim Fabric is available in 6 inch, 12 inch, 40 inch and 10 foot wide rolls. Each roll is 300 feet long.

Availability, Cost and Technical Assistance

CIM waterproofing materials are available worldwide.

Toll Free: 1-800-543-3458

Telephone: +1-603-924-9481

Email: information@cimind.com

Please visit our website www.cimindustries.com for product literature, MSDS's and application instructions.

Warranty

5-year material warranty. Please contact C.I.M.

Industries Inc. for availability of extended warranties.

Keeping Liquids Where They Belong



**C.I.M.
Industries
Inc.**

A Chase Corporation Company

Published data and specifications subject to change without notice.

www.cimindustries.com

23 Elm Street

Peterborough, NH 03458 USA

Tel 603.924.9481

800.543.3458

Fax 603.924.9482



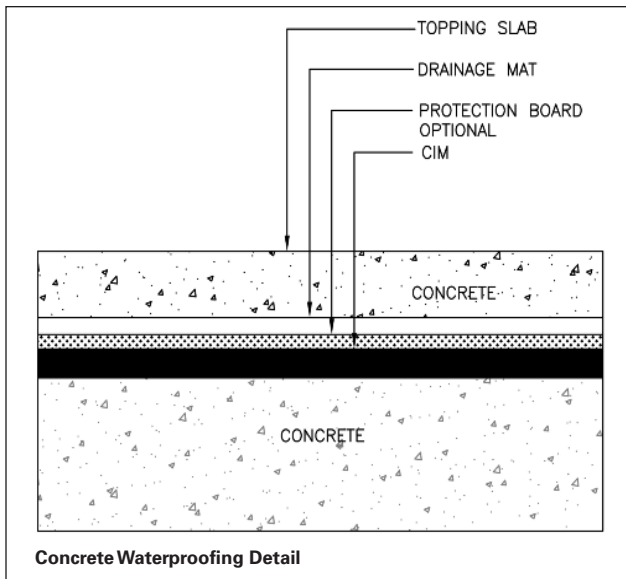

Application Instructions

Mixing - One gallon kits MUST be mixed with a 2-3 inch spiral mixer, and 4.5-5 gallon units MUST be mixed with an 8 inch mud mixer/drywall paddle using a slow speed ½" drill (450-900 rpm). Slowly pour the CIM Activator into the CIM Premix and mix for 3 minutes. CIM waterproofing materials are packaged with enough head space to mix the two components in the original packaging. Do not break down or split containers. CIM Activator is not a catalyst. Do not mix and match the activator and premix products. See CIM Instruction Guide IG-8 "Instruction Guide Mixing CIM Premix and Activator" for detailed information.

Application Methods

CIM may be applied with short nap phenolic core rollers, brushes, trowels, notched squeegees, or by glove. Once mixed the pot life of the CIM products is typically 15-30 minutes, and will vary depending on product and application temperatures. The minimum recommended thickness is 60 wet mils.

Non-Porous Surfaces - Surfaces must have an adequate profile to maximize adhesion. CIM may be applied directly to non-porous surfaces such as metals, glass, fiberglass, asphaltic materials, and certain plastics. Non-porous surfaces must be clean and dry prior to the application of CIM materials. Surfaces must be roughened to maximize

adhesion. Apply a light mist of CIM Bonding Agent no more than 1 hour prior to application of CIM waterproofing materials. CIM 61BG Epoxy Primer may be used in lieu of CIM Bonding Agent. See CIM Technical Data Sheets and Instruction Guides for detailed information.

Porous Surfaces - CIM waterproofing materials are commonly applied directly to porous surfaces such as concrete, wood and masonry. Porous surfaces must be clean and dry during the CIM application. Application must be performed when these surfaces are declining in temperature and out of direct sunlight in order to prevent outgassing. CIM 61BG Epoxy Primer may be used to limit outgassing.

Recoat Windows - CIM waterproofing systems have a minimum recoat window of 1 hour and a maximum recoat window of 4 hours at 70°F. Recoat windows will vary depending on temperature.

Joints - Joints in plywood or other similar construction materials may be reinforced with CIM Scrim Fabric. To install, first apply a 10-20 mil tack coat of CIM over joints, then immediately place the fabric into the wet CIM. Apply additional CIM over the fabric to achieve the minimum required thickness.

Drains and Penetrations - Use CIM 1000 Trowel Grade around all drains and penetrations to assure minimum film thickness. CIM Scrim may also be used as reinforcement. Drains and penetrations should be detailed prior to application of CIM materials to surrounding areas.

Coverage Rates

Theoretical Coverage

27 sq ft per gallon at 60 wet mils

5 gal units

CIM 800, CIM 1000 and CIM 1061 = 135 sq ft

4.5 gal units

CIM 1000 Trowel Grade = 121 sq ft

1 gallon kits (contains .8 mixed gallons)

CIM 1061 and CIM 1000 Trowel Grade = 21 sq ft

Dual Cartridges (850 ml cartridges)

CIM 1000 Trowel Grade = 4 sq ft

The coverage rate above do not account for waste or application over irregular surfaces. See CIM Coverage Charts for additional information. Most contractors use 20 sq ft per gallon for concrete or a 15%-20% waste factor.

Published data and specifications subject to change without notice.



www.cimindustries.com
23 Elm Street
Peterborough, NH 03458 USA

Tel 603.924.9481
800.543.3458
Fax 603.924.9482

